



DIMMbox and Light Control Box

Connection Options

...dimmed by FRIWO

...supplied by HAREDATA

DIMMBox Family

The **DIMMBox** family provides an easy to implement and cost effective PWM output dimming solution. With a switching frequency of 600Hz it provides “non-flicker” dimming from a variety of inputs – DALI; 1-10V Analog and Switch Dim/Push Dim.

Interfaces

- Input signals: 1-10 V, Push-Dim or DALI
- Connection to FRIWO LED drivers on input side / CTRL wire has to be connected in cc mode
- Brightness control by pulse width modulation control (PWM) of the LED output



Key Characteristics

- Input 15-48 VDC / 0-5 A
- Output 15-48 VDC / 0-5 A
- PWM 600 Hz
- DALI: according to DALI-Protocol
- Switch DIM: 230VAC
- Analog: 1-10V
- Ambient Temperature Range: -20C - 45C
- Low Leakage Current < 100microA
- Lifetime at 35C 100k hours.
- Weight 57g
- Dimensions H 21mm x W 30mm x L 153mm

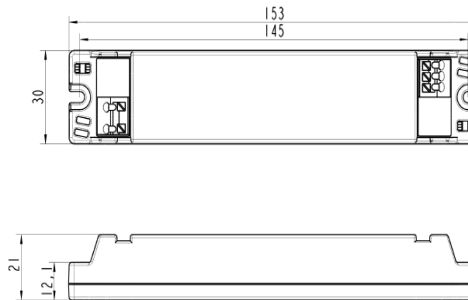

The **DIMMBox** family has a number of variants each offering extra features and so provide a variety of potential solutions for your lighting needs.

- **DIMMBox Standard (1894848)** – standard DIMMbox providing DALI; 1-10A and SWD dimming down to about 10%. Can potentially be used with 3rd party LED drivers.
- **DIMMBox 1-10 (1896084)** – each individual unit can be put into a sleep mode rather than turning the whole lighting system off.
- **DIMMBox CV (1897004)** – can dim down to 0.1% when used in Constant Voltage applications.

N.B. Whilst **DIMMBox** has been optimised for use with FRIWOs range of Constant Current and Constant Voltage LED drivers they can potential be used with 3rd party driver solutions.

Push-Dim Signal

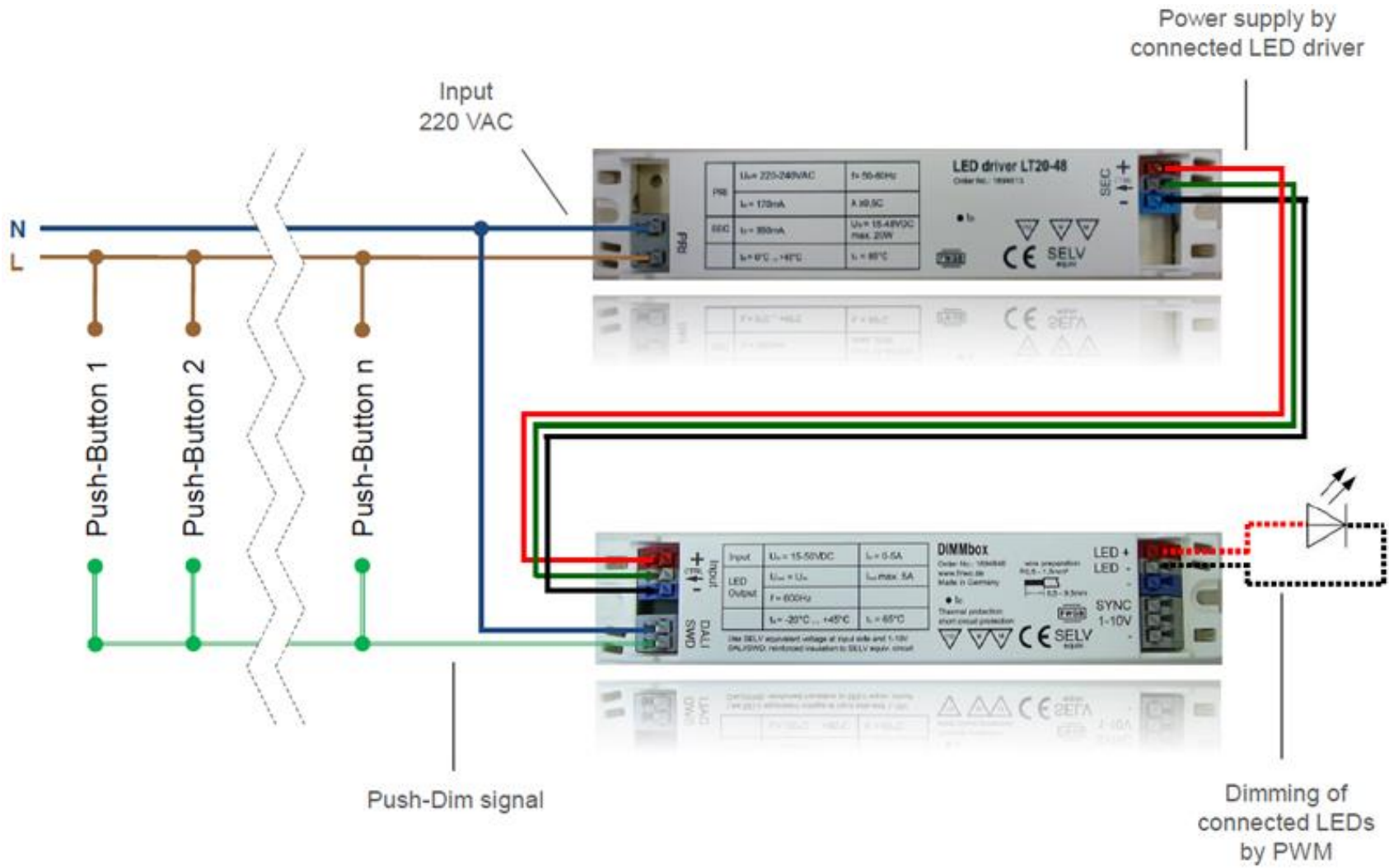

Push-Dim Signal

Multiple Operations with Push-Dim

- Synchronization of DIMMboxes via SYNC interface 1-10 V

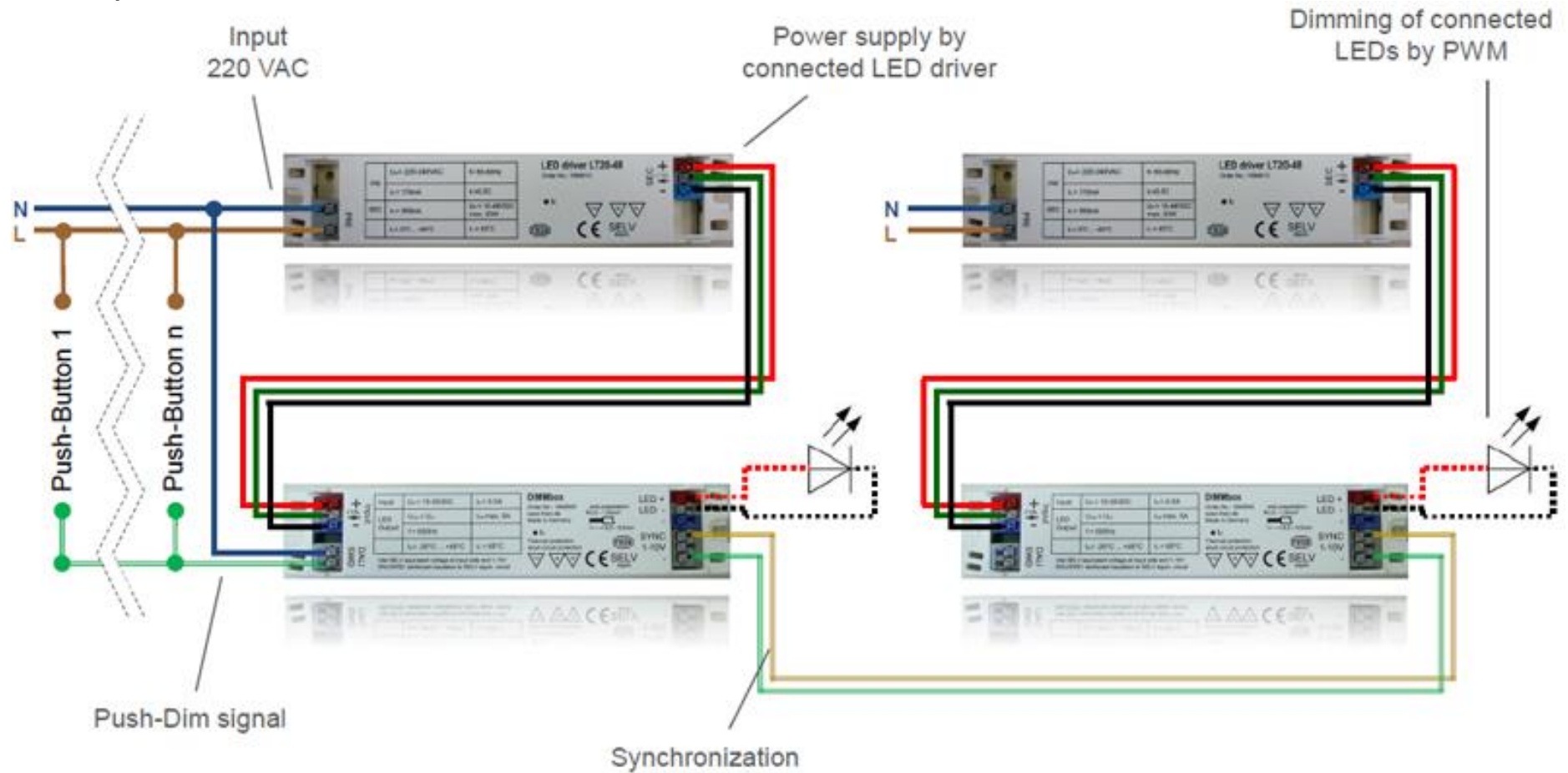

DALI Signal

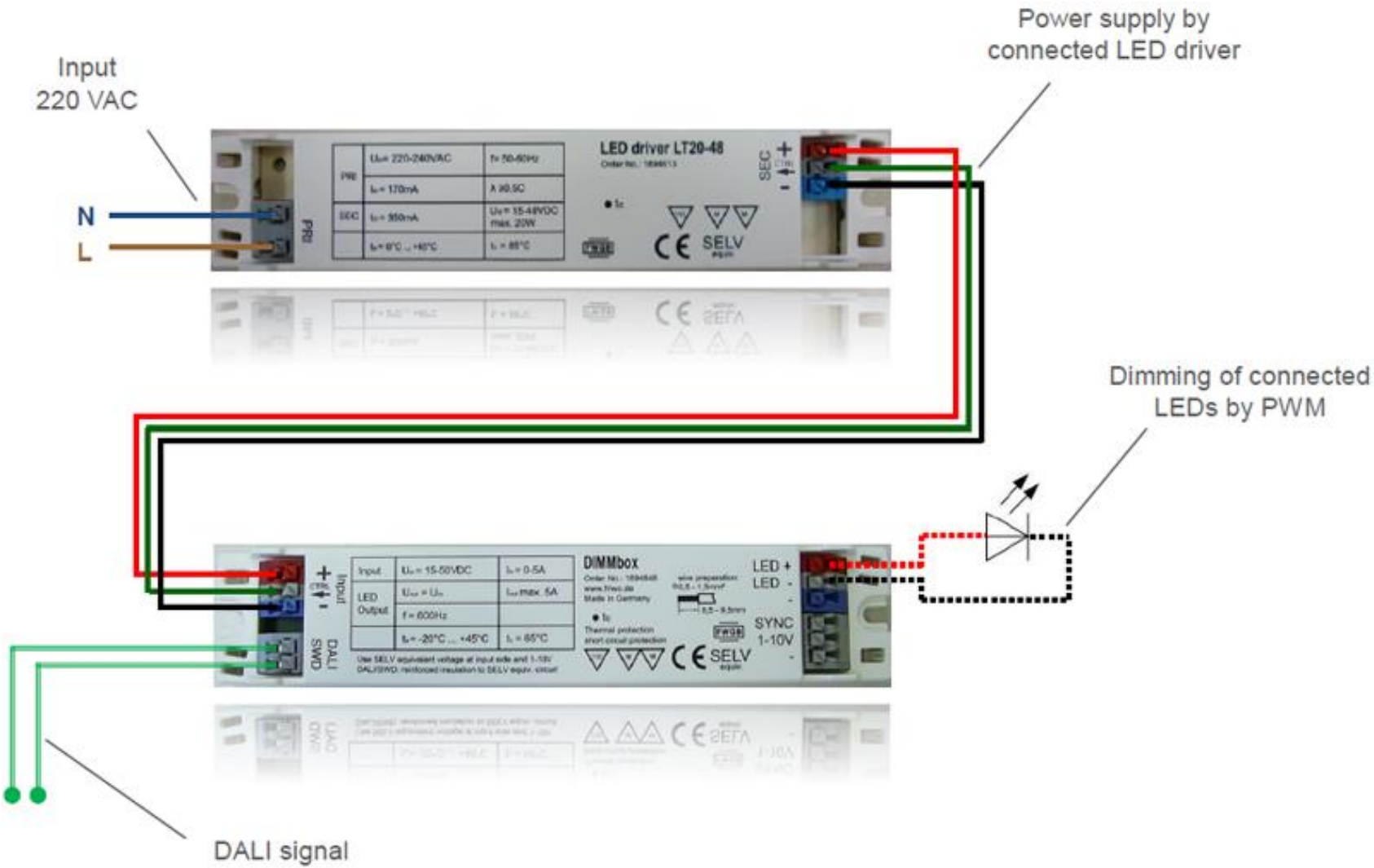

1-10 V Signal

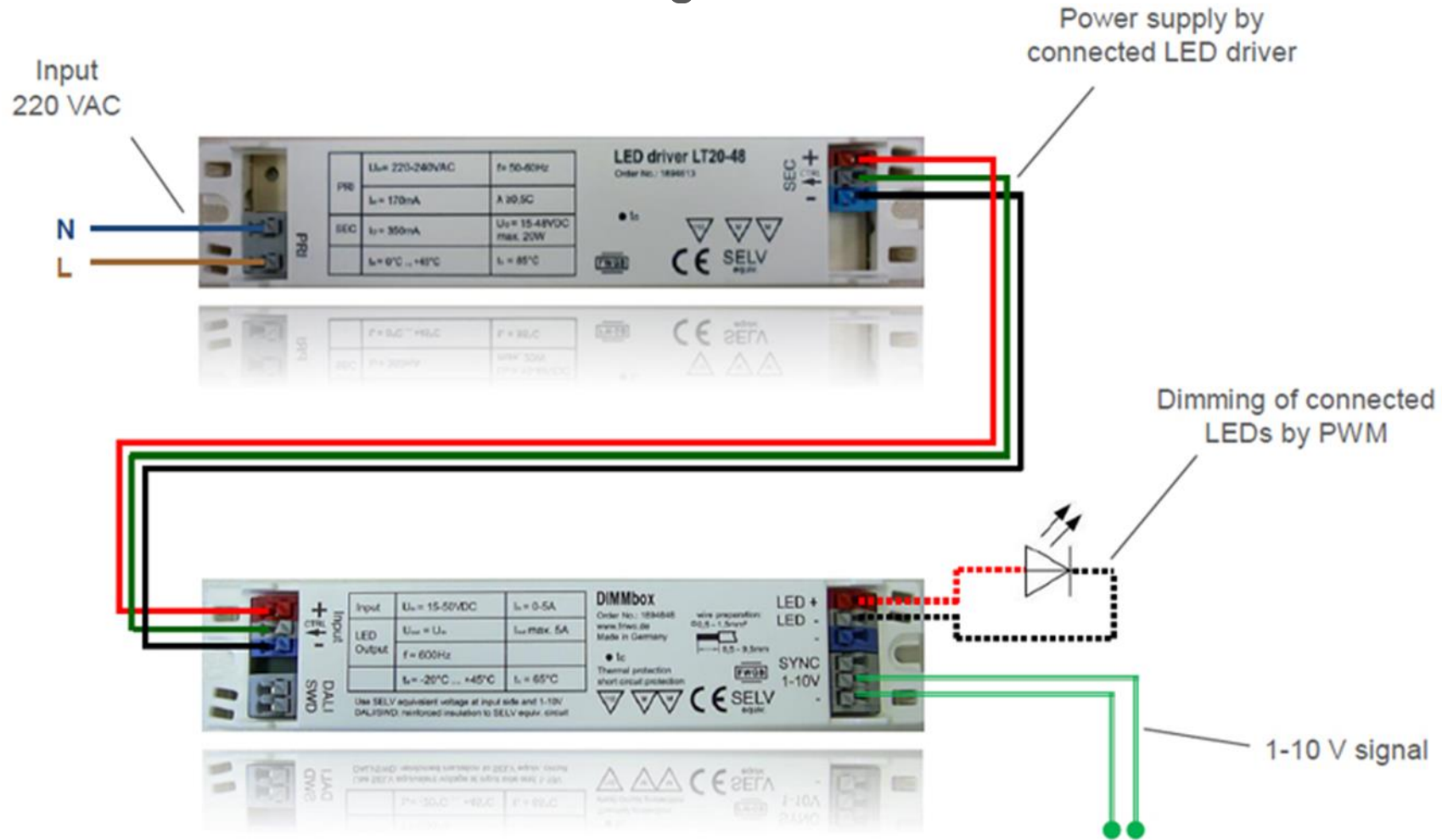

Light Control Box – LS12/100-DPA

The **LS12-100-DPA (1895885)** provides a great solution for light control systems. An extended 1-10V interface serves as the output whilst the device can take inputs from DALI; SWD/Push Dim; a PWM signal or 1-10V dimmer. The device can control up to 100 LT drivers that have the 1-10 input pin.

Interfaces

- Input signals: 1-10 V, Push-Dim, Dali or external sensor (e.g. presence detector)
- FRIWO LED drivers with integrated 1-10 V interface to be connected on the output side
- 12 VDC output to supply external applications with power
- Brightness control by linear current regulation of the LED driver.



DALI / Push-Dim Signal



1-10 V Signal



External Sensor

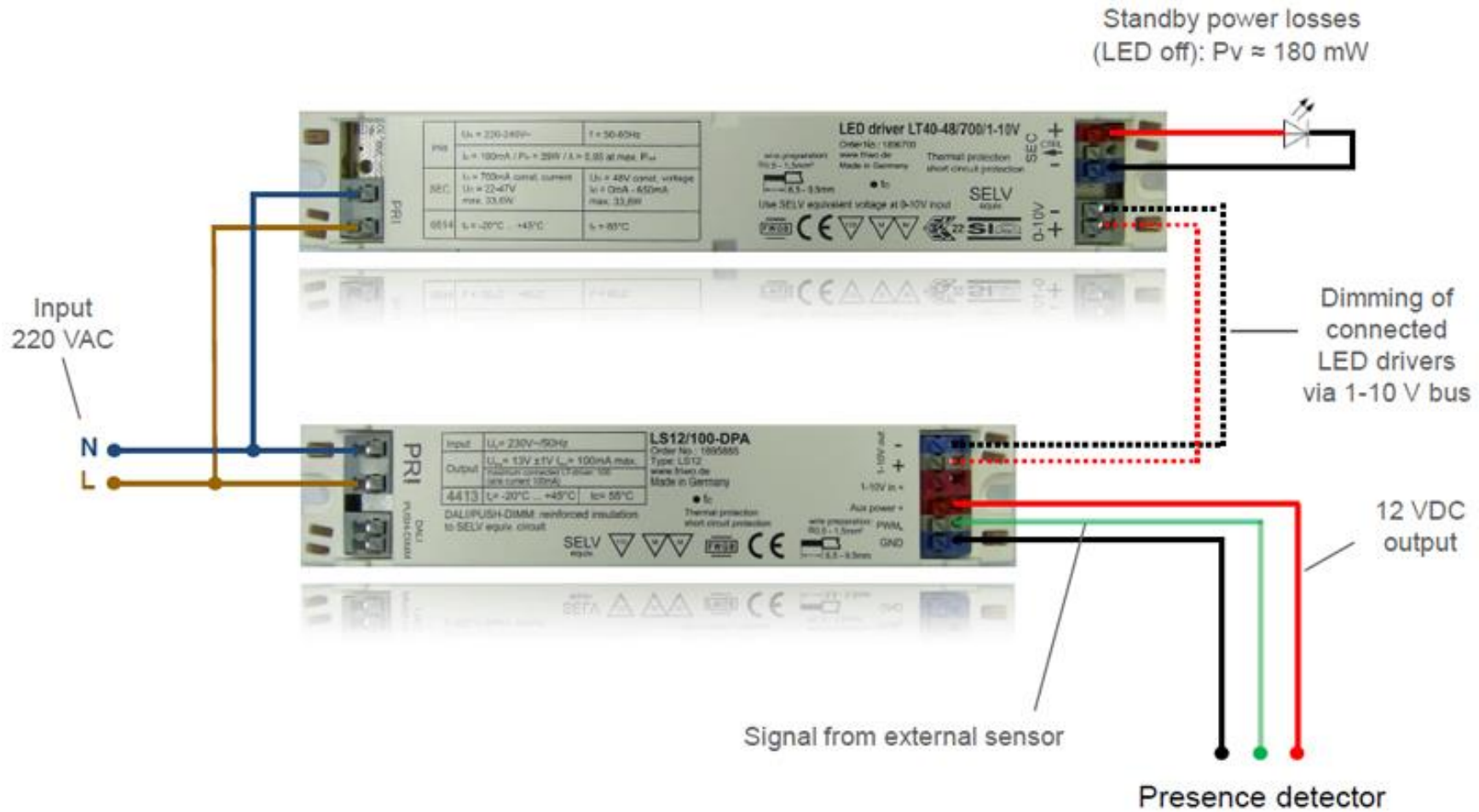

Control of Several Drivers

Control of up to 100 FRIWO LED drivers with integrated 1-10 V interface

